

ANCHOR BOLT LAYOUT

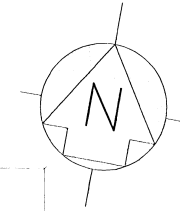

- ### NOTES
1. CONCRETE SHALL HAVE A MINIMUM ULTIMATE COMPRESSIVE CUBE STRENGTH OF 21MPa AT 28 DAYS.
 2. UNLESS OTHERWISE STATED CONCRETE COVER TO REINFORCEMENT SHALL BE 60mm MINIMUM.
 3. ANCHOR BOLTS SHALL BE SECURELY FIXED AND ACCURATELY PLUMBED.
 4. THE MAXIMUM ALLOWABLE DEVIATIONS BETWEEN CENTER LINES OF BOLT IN ANY GROUP SHALL BE ± 2mm.
 5. TOP OF BASES TO BE WOOD FLOAT FINISHED.
 6. 50mm THICK CONCRETE BLINDING TO BE PLACED AT BOTTOM OF EXCAVATION.
 7. MINIMUM LAP FOR RE-BARS IN CONCRETE BASE SHALL BE 255mm.
 8. TOP OF PLINTH ELEVATION FOR ALL BASES SHALL BE AS EXISTING BASES.
 9. ALL EXPOSED EDGES TO BE CHAMFERED (25mm x 25mm)
 10. REFER TO SHEET # 18308/1 FOR SITE LAYOUT.

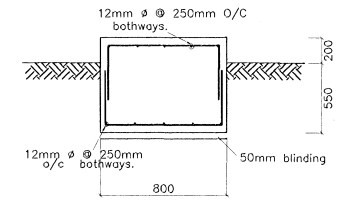

SECTION B - B

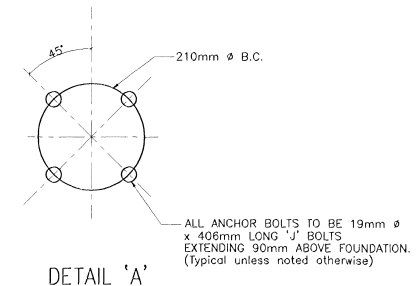

DETAIL 'A'

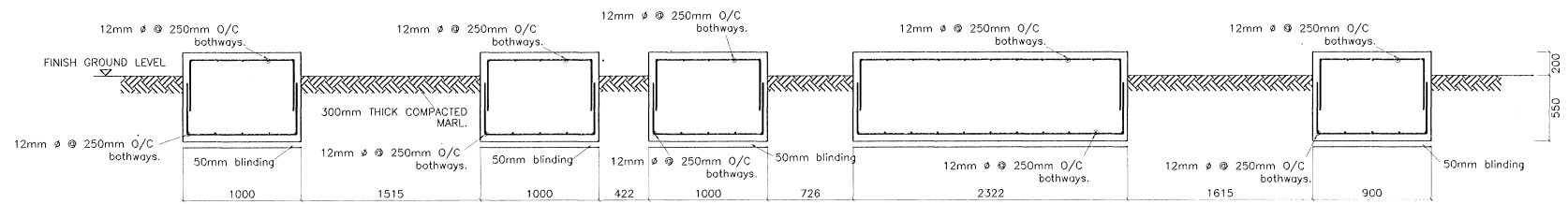

SECTION A - A

NO.		PARTICULARS		APP.	BY	DATE
REVISION						
JAMAICA PUBLIC SERVICE CO. LTD.						
KINGSTON JAMAICA						
VAR MANAGEMENT PROJECT '98'						
CARDIFF HALL 69/24KV SUBSTATION						
CAPACITOR BANK						
ANCHOR BOLT LAYOUT & BASE DETAILS						
DWG. SCALE: 1:6	DESIGNED BY: P.R.	MAY 98	DRAWING NO. 18339	REV. 1		
PLOT SCALE: 1:120	DRAWN BY: P.R.	MAY 98				
SUPPERSEDES: -	CHECKED BY: -			PROJECT NUMBER: IR 5708		
DATE: 28.05.98	APPROVED BY: P.S.					